



This device complies with CE regulations and meets the requirements of the applicable European guidelines.



Electronic old devices are valuable materials and do not belong in the domestic waste. If the device has reached the end of its operational life, please dispose of it in accordance with the applicable regulatory requirements of the local collection points. Disposal in general household waste is prohibited.



The device is compatible with the WPC Standard Spec. 1.1 "Qi". Please only use the device with Qi compatible devices.



Use only in dry indoors locations.

**QInside<sup>®</sup>**

Invisible wireless power charging



**Cover for Qi1001**

Step 1

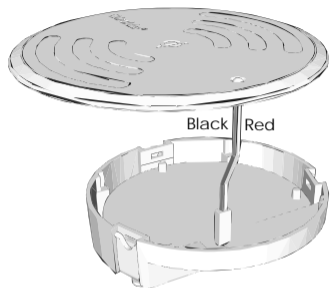

Step 2

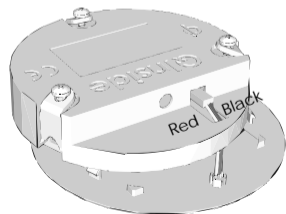

**Non detachable connection!**

Step 3

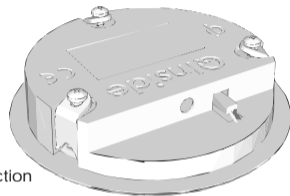

Step 4

